



PROFILES





ARLU, THE REFERENCE FOR OPENING DOORS

ARLU® is the manufacturer behind the brand names argenta® and rob®. Argenta has been a leading brand in door hardware for over 100 years, but today it is mainly synonymous with invisible door systems.

Minimalist architecture swears by clean lines and a "back to the essence" mentality. In terms of interior doors, this results in integrated door fittings, invisible integrated techniques, door frames and skirting boards for revolving, sliding and pivoting doors.

Argenta stands for a full range of sleek interior solutions.

PROFILES

- 4 upper rails
- 6 lower rails
- 7 handle profiles & reinforcement profiles
- 8 curtain rails
- 10 curtain accessories
- 11 wardrobe tubes
- 12 L-profiles
- 13 book shelf holders

Materials

- Aluminium: extruded aluminium profiles AlMgSi 0.5
(in accordance with EN 12020-2 and EN AW-6063)
- POM: PolyOxyMethylene
- Brute: untreated aluminium
- F1: natural colour (E6/EV1-SAA), anodised (20 micron)
- RAL: powder-coated (60-70 micron) in RAL colours such as RAL 9010 (pure white) ...
- Poli: gloss polished

PROFILES

ARLU® has developed a large selection of convenient and functional profiles for use in and around the house. These standard finishing profiles can be used in residential and utility building, both in new buildings and in renovation projects. The wide range of practical profiles is characterised by quality, durability and aesthetic finishing.



argenta
UPPER RAILS

upper rail type 11095



Technical drawing

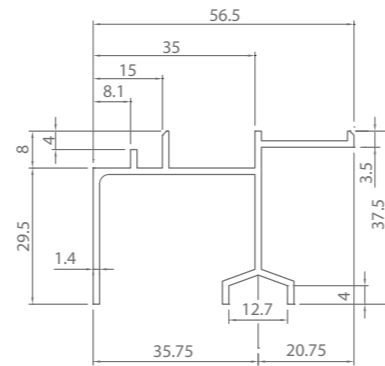

Technical properties

Material	Finishing	Length	Reference
Aluminium	F1	6 m	30501601
		7 m	30501701

Holes
Ø 4,75 mm, every 300 mm

Packaging
8 pieces

upper rail type 26402



Technical drawing

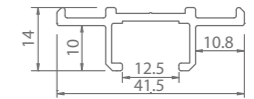

Technical properties

Material	Finishing	Length	Reference
Aluminium	F1	6 m	30502601
		7 m	30502701

Holes
Ø 5 mm, every 300 mm

Packaging
8 pieces

upper rail type 11100



Technical drawing

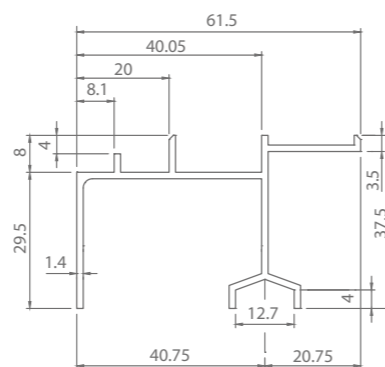

Technical properties

Material	Finishing	Length	Reference
Aluminium	F1	6 m	30503601
		7 m	30503701

Holes
Ø 4,75 mm, every 300 mm

Packaging
8 pieces

argenta
LOWER RAILS

lower rail type 9265 alu



Technical drawing

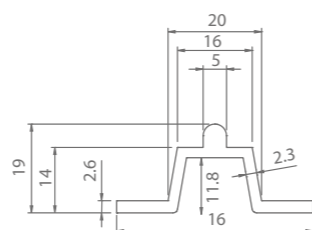

Technical properties

Material	Finishing	Length	Reference
Aluminium	F1	6 m	30401601
		7 m	30401701

Holes
Ø 4,25 mm, every 300 mm

Packaging
10 pieces

argenta
HANDLE PROFILES & REINFORCEMENT PROFILES

handle profile type 27667



Technical drawing

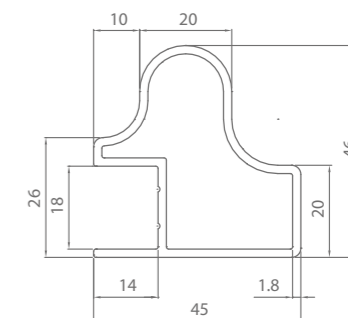

Technical properties

Material	Length	Finishing	Reference
Aluminium	2,5 m	F1	30805251
		BEL 9010	30805256

Holes
Ø 4,75 mm, every 300 mm

Packaging
1 piece

lower rail type 8966



Technical drawing

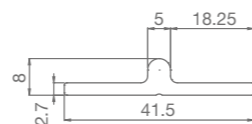

Technical properties

Material	Finishing	Length	Reference
Aluminium	F1	6 m	30403601
		7 m	30403701

Holes
Ø 4,25 mm, every 300 mm

Packaging
10 pieces

reinforcement profile type 27668



Technical drawing

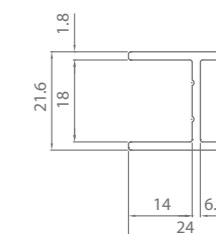

Technical properties

Material	Length	Finishing	Reference
Aluminium	2,5 m	F1	30806251
		BEL 9010	30806256

Holes
Ø 4,75 mm, every 300 mm

Packaging
1 piece

argenta
CURTAIN RAILS

curtain rail type 261



Technical drawing

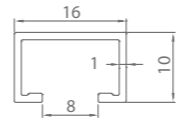

Technical properties

Material	Length	Finishing	Reference
Aluminium	6 m	F1	02610601
		white	02610606

Slot holes
6 x 3 mm, every 300 mm

Packaging
10 pieces

curtain rail type 263



Technical drawing

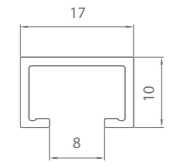

Technical properties

Material	Length	Finishing	Reference
PVC	6 m	white	02630606

Holes
Ø 3 mm, every 180 mm

Packaging
20 pieces

curtain rail type 262



Technical drawing

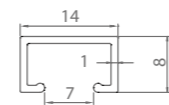

Technical properties

Material	Length	Finishing	Reference
Aluminium	6 m	F1	02620601

Slot holes
6 x 3 mm, every 300 mm

Packaging
10 pieces

argenta
CURTAIN ACCESSORIES

curtain hook type 265

Technical drawing



Technical properties

Material	Finishing	Packaging	Reference
POM	white	100 pieces	02650000

curtain slider type 266

Technical drawing

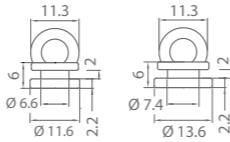

Technical properties

Material	Finishing	Packaging	Curtain rail size	Reference
POM	white	100 pieces	14 mm	02660100
			16/17 mm	02660200

end piece type 268

Technical drawing

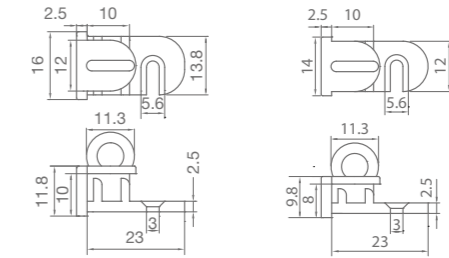

Technical properties

Material	Finishing	Packaging	Curtain rail size	Reference
POM	white	10 pieces	14 mm	02680100
			16-17 mm	02680200
		100 pieces	14 mm	02680101

argenta
WARDROBE TUBES

turn clamp part type 267

Technical drawing

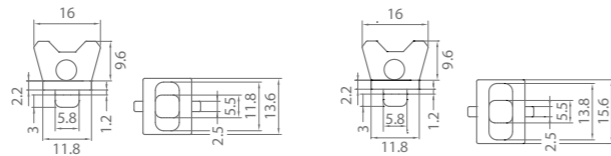

Technical properties

Material	Finishing	Packaging	Curtain rail size	Reference
POM	white	10 pieces	14 mm	02670100
			16/17 mm	02670200

wardrobe tube type 2600

Technical drawing

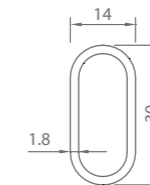

Technical properties

Material	Length	Finishing	Packaging	Reference
Aluminium	5 m	F1	10 pieces	30803501

argenta
L-PROFILES

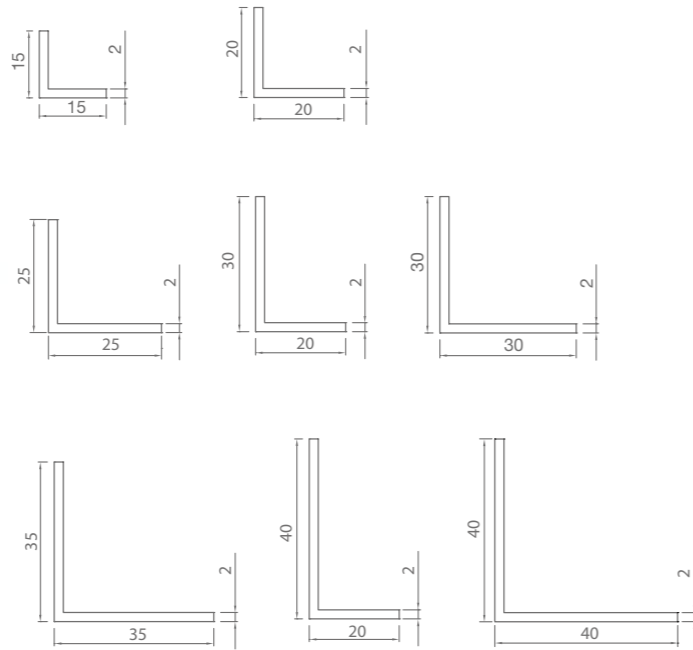

Material	Packaging	Finishing	Length	Maat	Reference
Aluminium	10 pieces	F1	6 m	15 x 15 x 2	30901601
				20 x 20 x 2	30902601
				25 x 25 x 2	30903601
				30 x 30 x 2	30905601
				40 x 20 x 2	30907601
				40 x 40 x 2	30908601
				brute	3 m
	20 x 20 x 2	30902300			
	25 x 25 x 2	30903300			
	30 x 30 x 2	30905300			
	6 m	15 x 15 x 2	30901600		
		20 x 20 x 2	30902600		
		25 x 25 x 2	30903600		
		30 x 30 x 2	30905600		
40 x 20 x 2	30907600				

argenta
BOOK SHELF HOLDERS

built-in book shelf holder type 252

Technical drawing

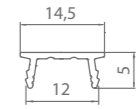

Technical properties

Material	Finishing	Packaging	Length	Reference
Aluminium	F1	20 pieces	2 m	02520201
			3 m	02520301



book shelf holder for surface mounting type 253

Technical drawing

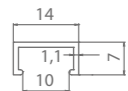

Technical properties

Material	Finishing	Packaging	Length	Reference
Aluminium	F1	20 pieces	2 m	02530201
			3 m	02530301



double hook type 253

Technical drawing

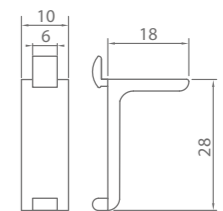

Technical properties

Material	Finishing	Packaging	Reference
Aluminium	F1	100 pieces	02550201





Ter Vlucht 2 +32 (0)51 27 05 00
8850 Ardoonie info@arlu.be
Belgium WWW.ARLU.BE

